



301 N. Hillcrest
Sulphur Springs, TX 75482

2000 I-30 E
Greenville, TX 75402

108 W. Marble
Wylie, TX 75098

Monday, May 4, 2020

Office of Hopkins County Judge
PO Box 288
Sulphur Springs TX 75483

Farmers Electric Cooperative Member: JASON D POUNDS
Service Order Number: 2020014647

Greetings:

Farmers Electric Cooperative, Inc. is requesting permission to construct electrical power distribution facilities which will build 6 spans of overhead service down and then cross County Road 1127 which is located 0.7 miles south of CR 1120 in Hopkins County, Texas.

Site location map and construction sketches are enclosed. The construction sketch details the proposed work. All road crossings will have a minimum vertical clearance of 22 feet.

If you have any questions, please contact me at any time.

Sincerely,

Meagan Lee

Project Coordinator
meaganl@farmerselectric.coop
Phone 903-441-1368

Submitted by Linda Graham
lgraham@farmerselectric.coop
Field Engineering Coordinator

Enclosures

County Approval Section:

Approved:

Denied:

Authorized Signature: *Mickey Baker*

Date: *5/4/20*

CR 4129

CR 4120

CR 1120

CR 1123

FM 275

CR 1127

HOPKINS



FARMERS ELECTRIC COOP
S/O 2020014647
JASON POUNDS
STARTING AT POLE 060080 &
BUILDING 7 SPANS PRIOR TO
CROSSING CR



POLE
060080

CR 1126

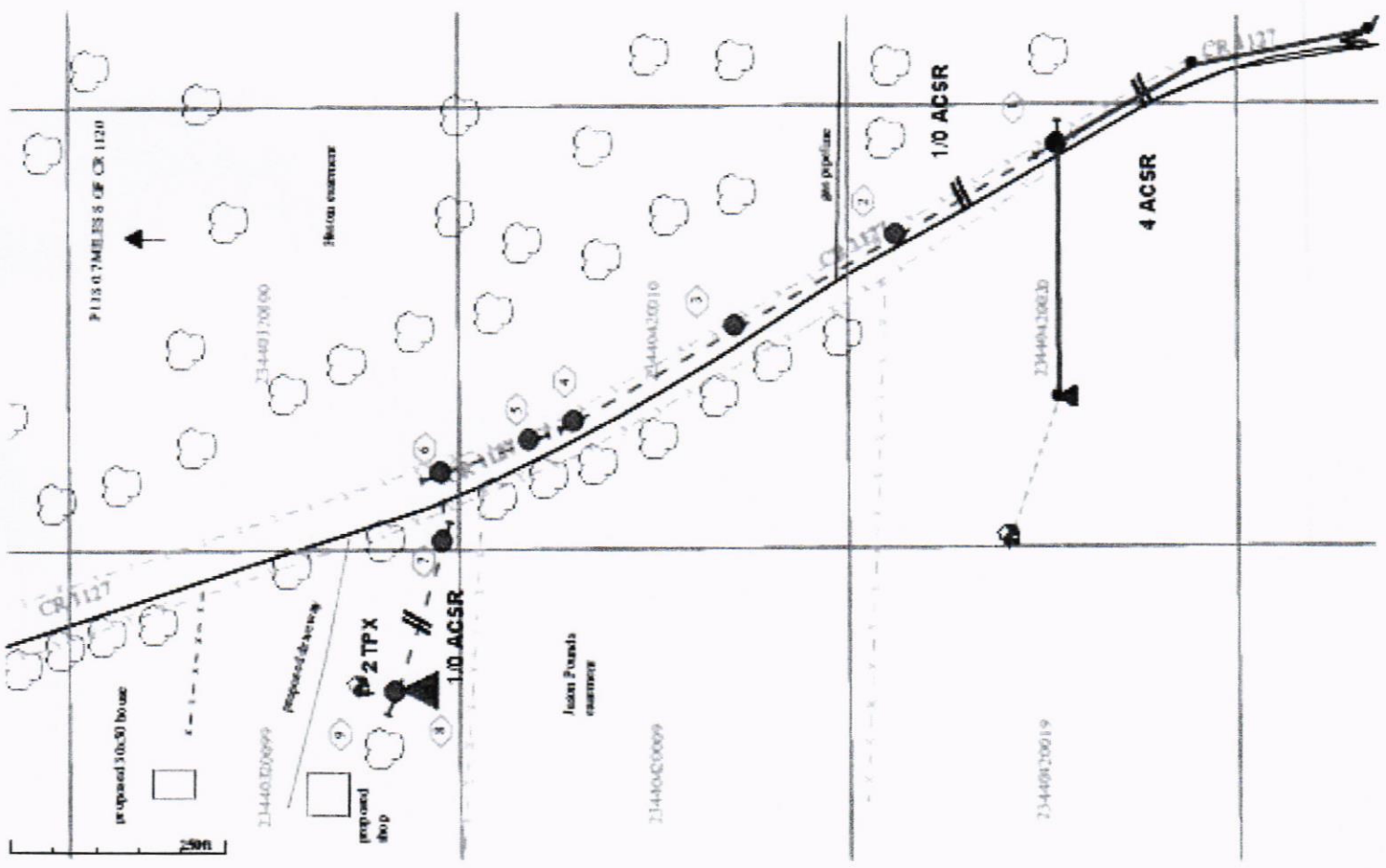

PLUS 0.7 MILES S OF CR 1120

thru easement

2344000000

2344000010

1/0 ACSR

4 ACSR

CR 117

CR 117

proposed 10x30 house

2344000009

proposed driveway

2 TYP X

1.0 ACSR

Asian Forests easement

2344000009

2344000019

75ft